

SECTIUNE S1 - DEMOLARE

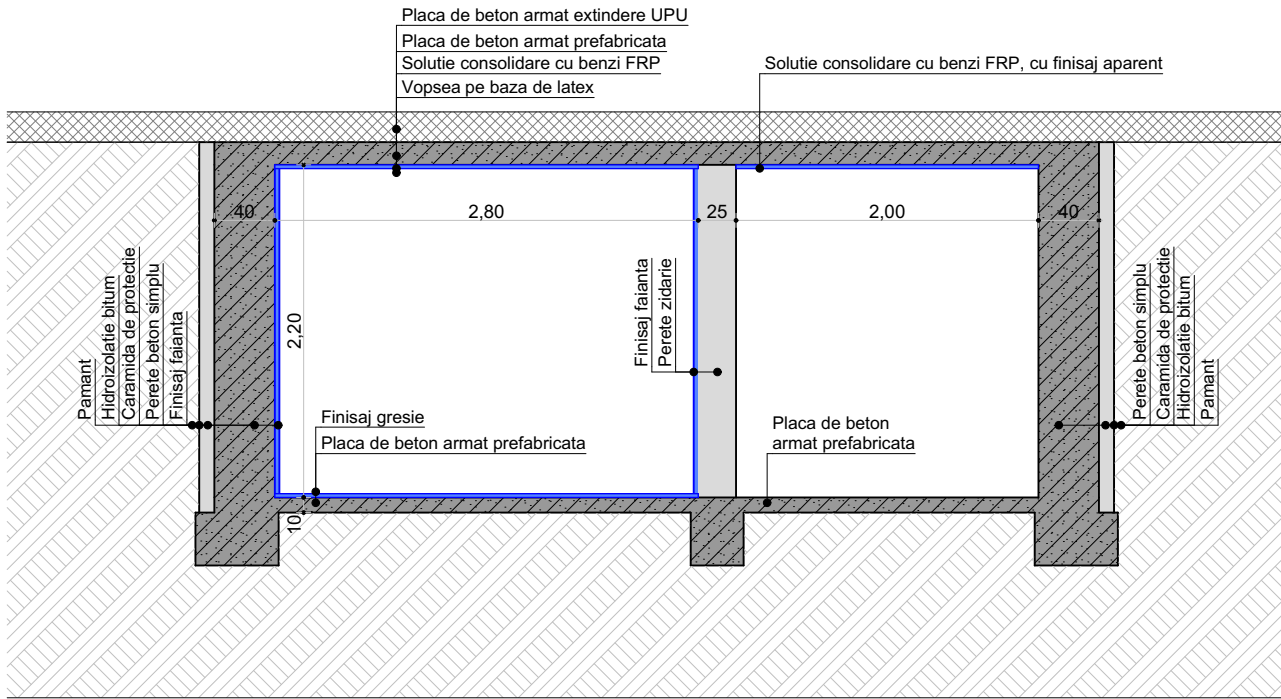

SECTIUNE S1 - PROPUNERE

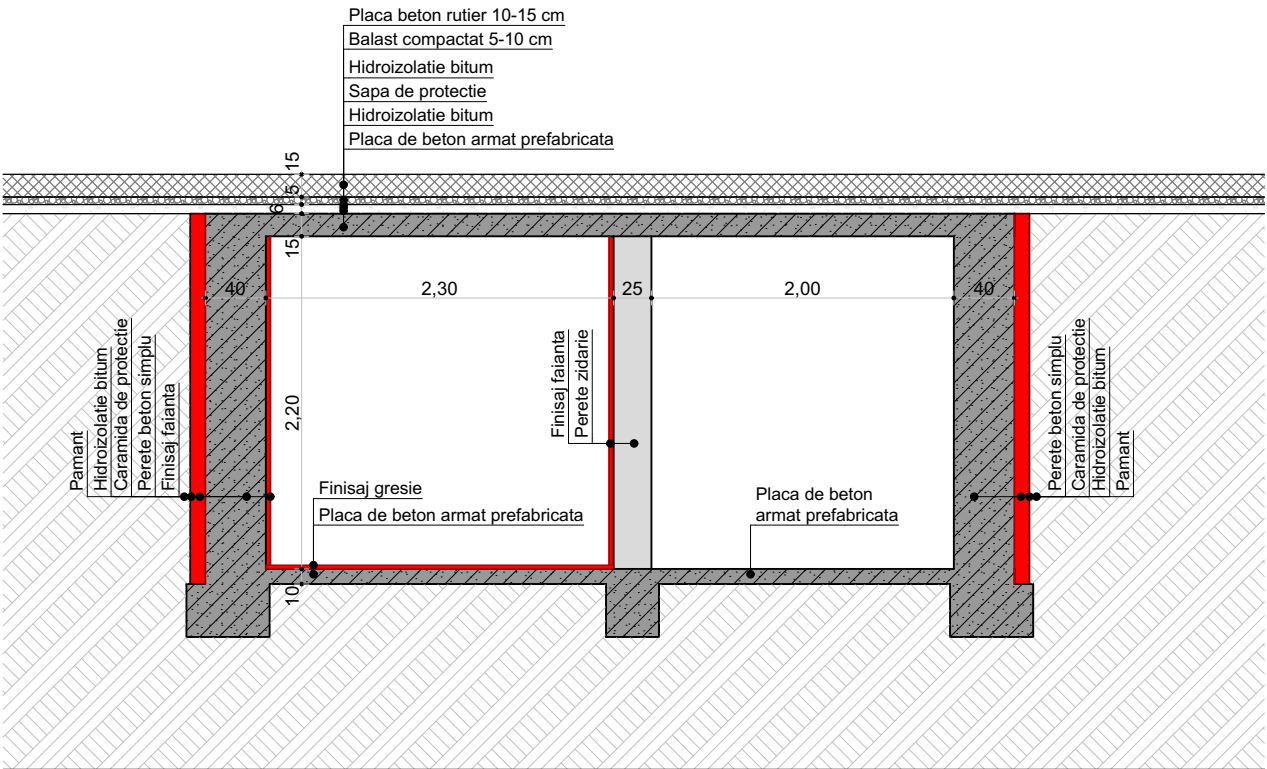

SECTIUNE S2 - DEMOLARE

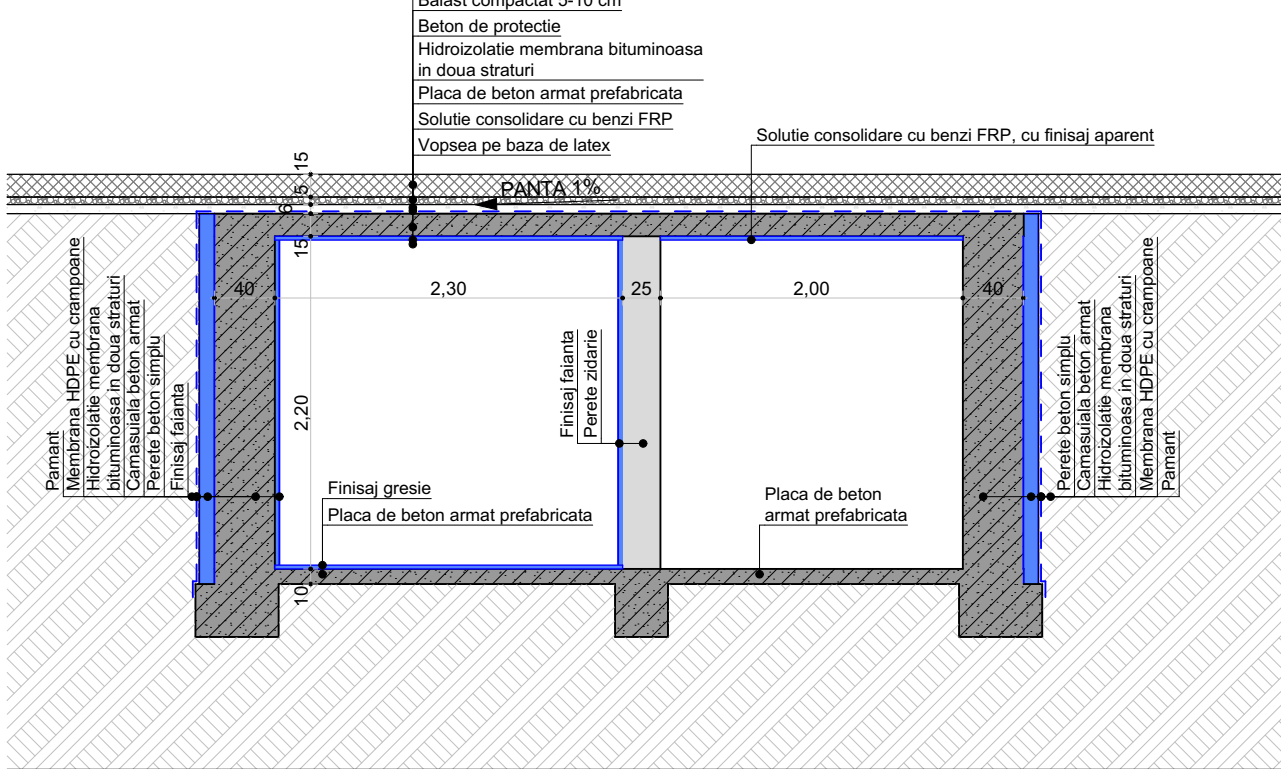

SECTIUNE S2 - PROPUNERE

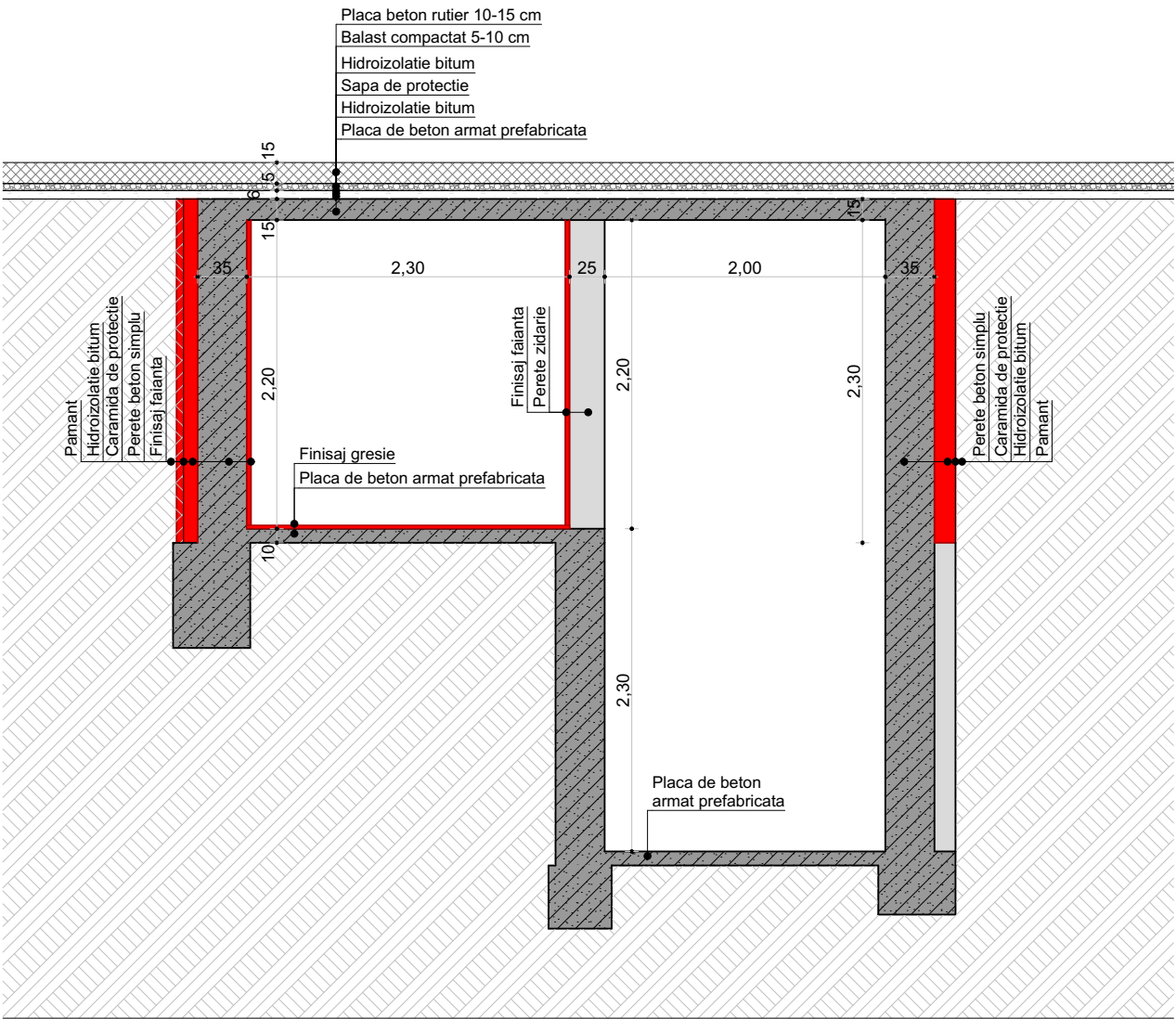

SECTIUNE S3 - DEMOLARE

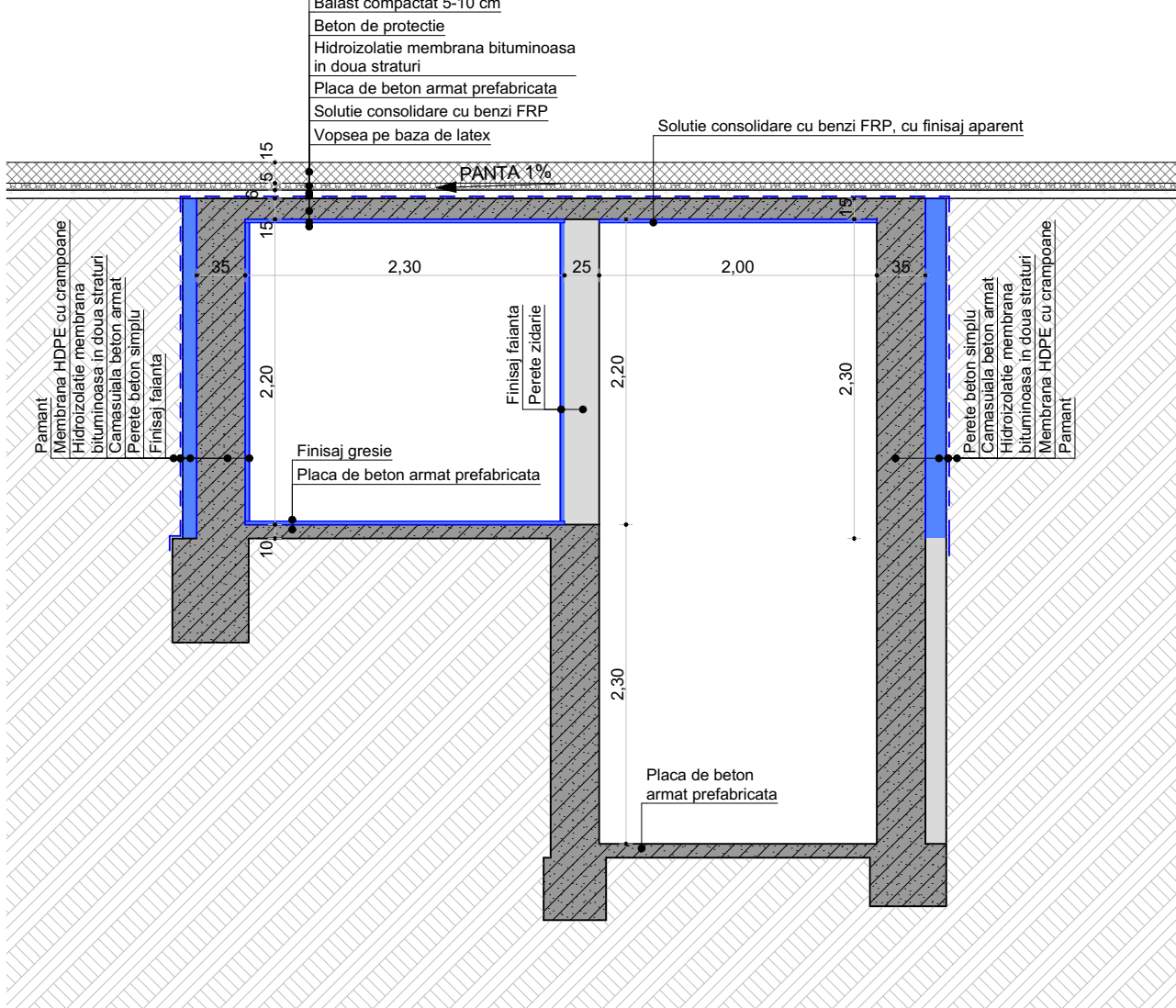

SECTIUNE S3 - PROPUNERE

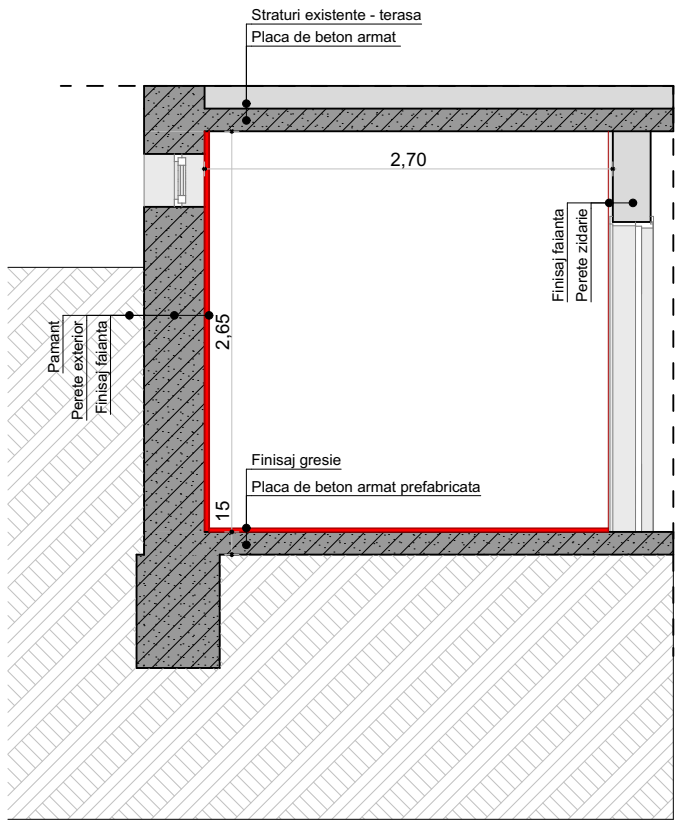

SECTIUNE S4 - DEMOLARE

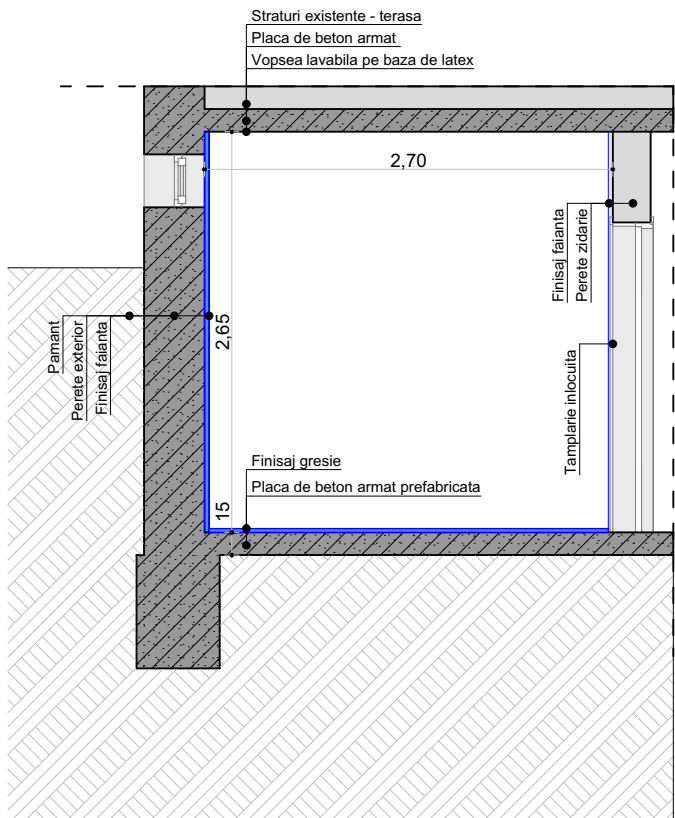

SECTIUNE S4 - PROPUNERE

LEGENDA

- ELEMENT BETON
- ELEMENT ZIDARIE
- ELEMENT DEMOLAT
- ELEMENT PROPUS

CATEGORIA DE IMPORTANTA: A
CLASA DE IMPORTANTA: II
GRAD REZISTENTA LA FOC: I
RISC MIC DE INCENDIU

PROIECTANT GENERAL:		BENEFICIAR				
ASOCIEREA EST RISE ARCHITECTURE S.R.L. - CONSWOOD STRUCTURES S.R.L.		SPITALUL JUDETEAN DE URGENTA PITESTI				
PROIECTANT DE SPECIALITATE: ARHITECTURA		ADRESA AMPLASAMENT: aleea Spitalului, Nr.36, Loc. Pitesti, jud. Arges				
EST RISE ARCHITECTURE S.R.L.		DENUMIRE PROIECT				
adresa: Str. Paravolator, nr.1, Bl. 150, Sc. 1, Et.6, Ap.36, Sector 4, camera 2, Bucuresti tel: 0731.835.383 e-mail: epure.stefan95@gmail.com CUI: 49170261		REABILITARE SI REPARATII PASAJ SUBTERAN DE LEGATURA SI CANIVOU - SEDIUL CENTRAL AL SPITALULUI JUDETEAN DE URGENTA PITESTI				
		TITLU PLANSA				Proiect nr. EST1/2024
	NUME	SEMNATURA		SECTIUNI		Faza: PTE
Sef proiect	arh. Stefan Epure					Arhitectura
Proiectat	arh. Stefan Epure			SCARA	DATA	REVIZIE
Desenat	arh. Stefan Epure			1:50	Mai. 2024	00
				PLANSA	1/1	A-04